

Thimbles: A Water Saving Device

Water usage/wastage can be reduced by:

a. Changing the water usage practices

- Reducing the water flow rate (slows down the flow of water)
- Reduce the duration of water usage

b. Installing water-saving devices

- Example 1: *Thimbles* which will help in reducing the flow rate of water
- Example 2: Installing a water storage bag in the cistern will reduce the water consumption in the toilet

How to Install Thimbles

Thimbles can be installed inside faucets in kitchen, the hose and showerhead

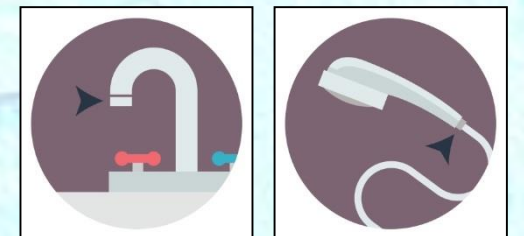

- First, remove the aerator.
- Second, replace the washer inside aerator with thimbles. Finally, reinstall the aerator.

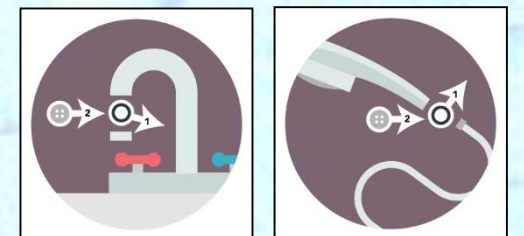

Please use thimbles and monitor your water usage from time to time through water bills.

Thimbles: Alat Penjimatan Air

Penggunaan / pembaziran air boleh dikurangkan dengan:

a. Perubahan amalan penggunaan air

- Mengurangkan kadar aliran air (memperlahankan air yang mengalir)
- Kurangkan tempoh penggunaan air

b. Memasang alat penjimatan air

- Contoh 1: *Thimbles* akan membantu mengurangkan kadar aliran air
- Contoh 2: Memasang beg simpanan air di sistern akan mengurangkan penggunaan air di dalam tandas

Cara pemasangan *thimble*

Thimbles boleh dipasang pada paip sinki di dapur, hujung hos dan “showerheads”.

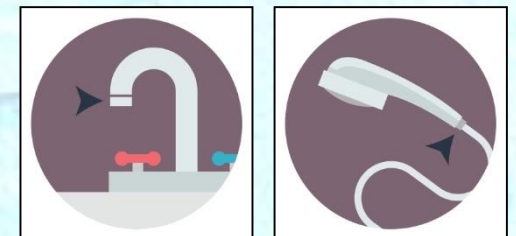

- Pertama, buka pengudara.
- Kedua, gantikan “washer” dengan thimbles. Akhir sekali, sila pasang balik pengudara.

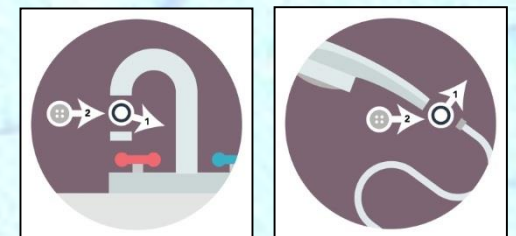

Sila gunakan *thimbles* dan pantau penggunaan air anda dari semasa ke semasa melalui bil air